



91 Panorama Drive Bonny Hills NSW

3 2 1

Enjoying a private position this beautifully presented residence offers the most for an easy lifestyle.

Step inside and be captivated by this home with level floorplan, three-bedrooms, two-bathrooms, a good-sized kitchen with adjacent meals area and plenty of storage. Conveniently designed throughout, the neutral interiors of the generous size living space are bathed in natural light and connect to an enclosed sunroom that overlooks a north/eastern aspect and the garden surrounds.

The main bedroom features a walk-through robe to ensuite bathroom, while the main bathroom and separate toilet serves the two additional bedrooms, each with built-in robes. Complete with ducted air-conditioning, an enclosed patio, established gardens with 2 sheds, spacious and fully fenced yard at the rear, large single remote garage and off-street caravan or boat parking options this property has everything to offer.

Located just 650m from the Bartlett Beach & Reserve and easy access to shops, café and Medical Centre, this property presents an exceptional opportunity for a comfortable and convenient lifestyle.

This spacious three-bedroom home is ready to move in and will appeal to a broad range of buyers including families,

Land Size : 754 sqm

View : <https://www.jandsrealestate.com.au/sale/nsw/mid-north-coast/bonny-hills/residential/house/7610329>



Jon Slater
02 6586 3333



Kylie Moss
02 6586 3333

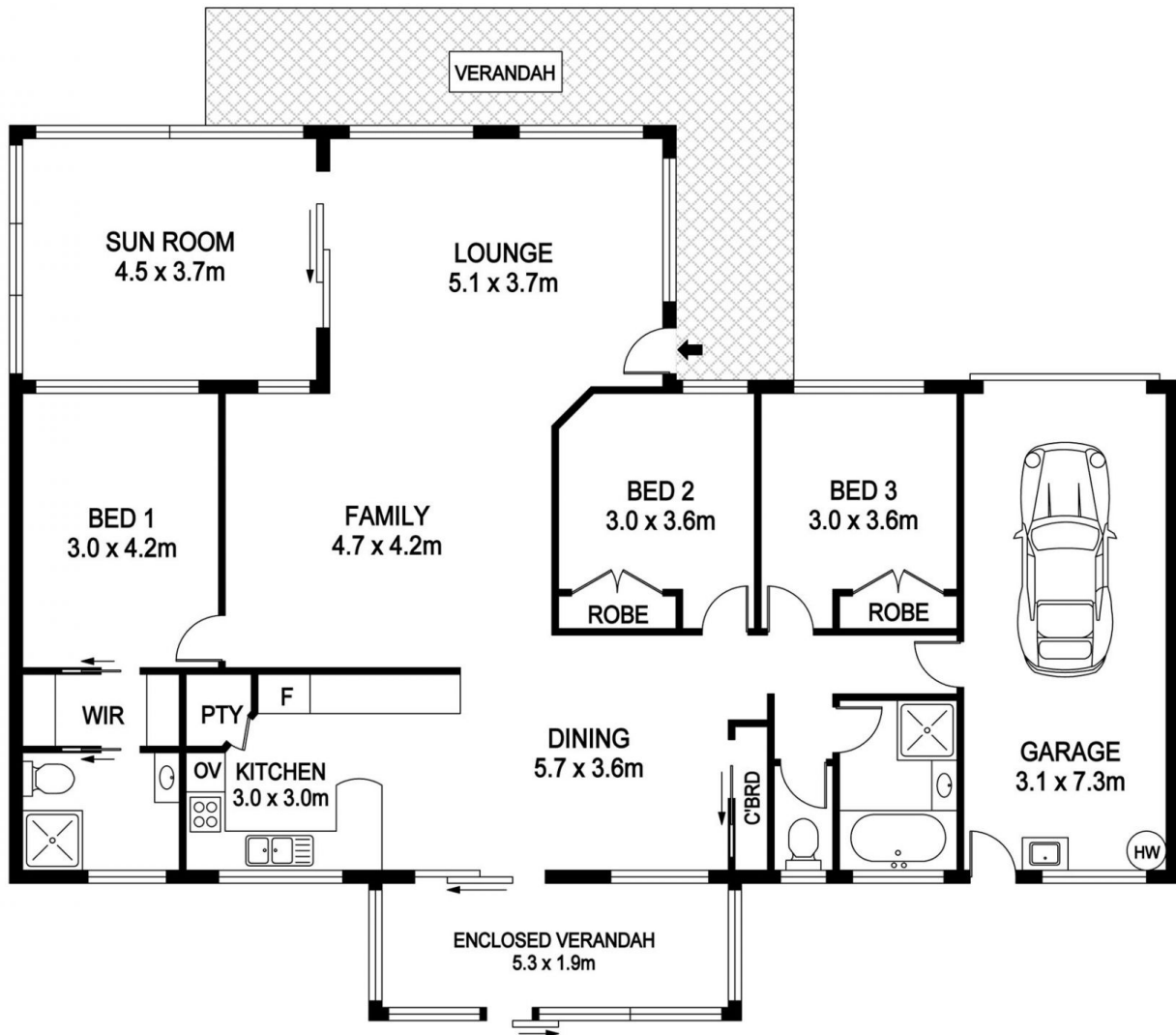

91 Panorama Drive, Bonny Hills

INTERNAL : 177.1m²

DISCLAIMER

PLANS SHOWN ARE FOR MARKETING PURPOSES ONLY. ALL DIMENSIONS ARE APPROXIMATE AND NOT TO SCALE. THEY ARE SUBJECT TO ERRORS AND INACCURACIES AND NO LIABILITY WILL BE ACCEPTED. INTERESTED PARTIES SHOULD MAKE THEIR OWN INQUIRES.

